

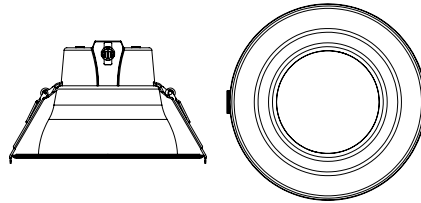

Questions?

For customer service please call us at 1-310-787-1100
Office Hours: 8:00 a.m. – 5:00 p.m. PST Monday-Friday



6"-8" LED
Commercial Downlight

PLEASE REVIEW THE INSTRUCTIONS AND WARNINGS LISTED BELOW PRIOR TO PROPER INSTALLATION

Read carefully before installing a fixture. Retain these instructions for future reference.

This fixture must be wired in accordance with the National Electrical Code and all applicable local codes. Proper grounding is required for safety. This product must be installed in accordance with the applicable installation code by a person familiar with the construction and operation of the product and the hazards involved.

WARNINGS

- Risk of electrical shock. Disconnect power at fuse or circuit breaker before installing or servicing.
- To prevent early lamp failure, the lamp should only be installed in operating environments ranging between -30°C and +40°C (-22°F and +104°F).
- No user-serviceable parts inside. To avoid electrical shock do not disassemble the product.
- Risk of fire or electric shock. LED Retrofit Kit installation requires knowledge of luminaires' electrical systems. If not qualified, do not attempt installation. Contact a qualified electrician.
- Risk of fire or electric shock. Install this kit only in luminaires that have the construction features and min dimensions are shown in the Template and where the input rating of the retrofit kit does not exceed the input rating of the luminaire.
- Do not make or alter any open holes in an enclosure of wiring or electrical components during kit installation
- To prevent wiring damage or abrasion, do not expose wiring to edges of sheet metal or other sharp objects.
- Installers should not disconnect existing wires from lamp holder terminals to make new connections at lamp holder terminals, Instead, installers should cut existing lamp holder leads away from the lamp holder and make new electrical connections to lamp holder lead wires by employing applicable connectors.
- This Retrofit kit is accepted as a component of a luminaire where the suitability of the combination shall be determined by authorities having jurisdiction. The product must be installed by a qualified electrician in accordance with the applicable and appropriate electrical codes. The installation guide does not supersede local national regulations for electrical installation

CAUTION

- **The risk of fire. Consult a qualified electrician to ensure the correct branch circuit conductor.**

INSTRUCTIONS

WHAT'S IN THE BOX

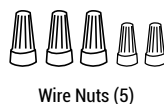
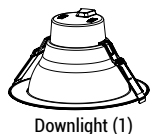

TOOLS NEEDED

This LED Recessed Kit requires very few tools for installation. A screwdriver and a pair of wirecutters will help to install.

OPTIONAL ACCESSORIES

Goof Ring



8-10 GR
for extending from 8-1/4" to 10-1/2"
Maximum Ceiling Cutout 9"

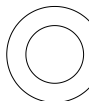

10-12 GR
for extending from 10-1/4" to 12-1/2"
Maximum Ceiling Cutout 10-15/16"



12-14 GR
for extending from 11-1/2" to 14-3/16"
Maximum Ceiling Cutout 12-3/8"

T-Plate

New construction or remodel plate for T-grid ceilings

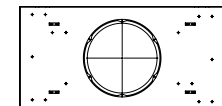

SJ-Plate

New construction plate for Stud/Joist

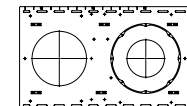



Questions?

For customer service please call us at 1-310-787-1100
Office Hours: 8:00 a.m. – 5:00 p.m. PST Monday-Friday

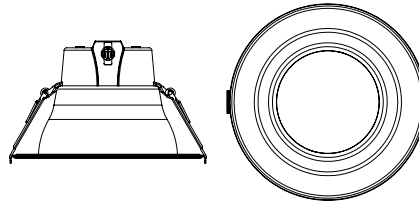

**6"-8" LED
Commercial Downlight**

PLEASE REVIEW THE INSTRUCTIONS AND WARNINGS LISTED BELOW PRIOR TO PROPER INSTALLATION

INSTALLATION WITH EXISTING FRAME

1. Shut power OFF to the fixture.
2. Remove the old housing for a lamp. (Fig.1)

Fig.1

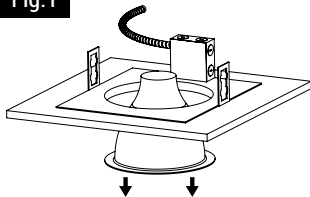

3. Attach the carabiner safety clip to the existing fixture. (Fig.2)

Fig.2

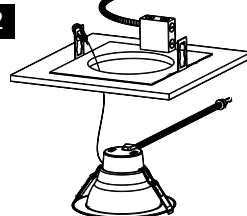

4. Remove junction box faceplate. Disconnect all wires to the ballast and remove the ballast from J-Box. Remove appropriate round knock out and attach the fixture conduit whip into the knockout. Connect incoming power (White to White, Black to Black, Green to Green/Ground). For 0-10V dimming circuits, connect Grey to Grey and Purple to Purple. Reattach J-Box faceplate. (Fig.3)

Fig.3

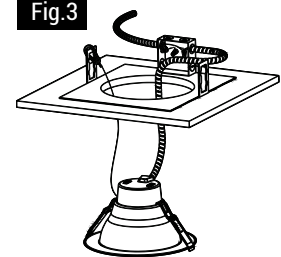

5. Adjust the fixture power to the desired lumen output by sliding the black selector switch. Adjust the color temperature to the desired one, by sliding the red selector switch. (Fig.4)

Fig.4

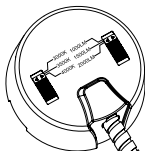

6. Install the downlight by lifting both retention tabs upward. (Fig.5)

Fig.5

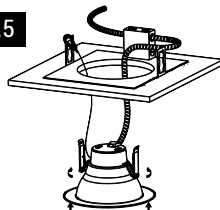

7. Push until the trim sits flush against the ceiling. (Fig.6)

Fig.6

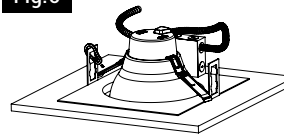

8. Restore power at the source and the installation is complete.

Note: These instructions do not cover all details or variations in equipment nor do they provide for every possible situation during installation, operation or maintenance.

INSTALLATION WITHOUT EXISTING FRAME

1. Make sure the POWER IS TURNED OFF at the source to the location in which you are installing the product.
2. Use a template inside the box to cut a hole in the ceiling. (Fig.7)

Fig.7

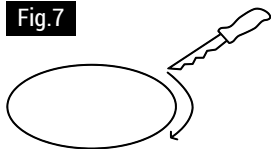

3. Select the desired lumen output and CCT. (Fig. 8)

Fig.8

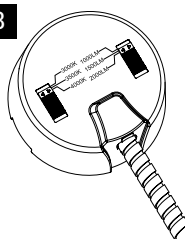

4. Insert lamp conduit into a preinstalled J-box (not provided) and wire to the power source (black to hot, white to neutral, green to the ground). For 0-10V dimming circuits, connect grey to grey and purple to purple. Close the J-box securely. Install the downlight by lifting both retention tabs upward. (Fig. 9)

Fig.9

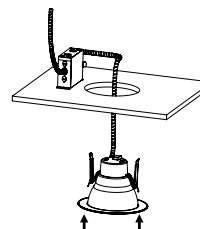

5. Push until the trim sits flush against the ceiling. (Fig.10)

