

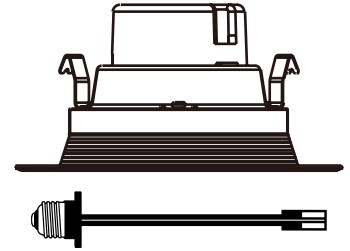

Questions?

For customer service please call us at 1-888-743-5766
Office Hours: 8:00 a.m. – 5:00 p.m. PST Monday-Friday



PLEASE REVIEW THE INSTRUCTIONS AND WARNINGS LISTED BELOW PRIOR TO PROPER INSTALLATION

WARNINGS	CAUTIONS
<ul style="list-style-type: none"> WARNING - Risk of fire or electric shock. LED Retrofit Kit installation requires knowledge of luminaires electrical systems. If not qualified, do not attempt installation. Contact a qualified electrician. WARNING - Risk of fire or electric shock. Install this kit only in luminaires that have the construction features and dimensions shown in the photographs and/ or drawings and where the input rating of the retrofit kit does not exceed the input rating of the luminaire. Do not make or alter any open holes in an enclosure of wiring or electrical components during kit installation. WARNING - To prevent wiring damage or abrasion, do not expose wiring to edges of sheet metal or other sharp objects. Installers should not disconnect existing wires from lampholder terminals to make new connections at lampholder terminals. Instead installers should cut existing lampholder leads away from the lampholder and make new electrical connections to lampholder lead wires by employing applicable connectors. THIS RETROFIT KIT IS ACCEPTED AS A COMPONENT OF A LUMINAIRE WHERE THE SUITABILITY OF THE COMBINATION SHALL BE DETERMINED BY AUTHORITIES HAVING JURISDICTION 	<ul style="list-style-type: none"> Suitable for use with dimmers. Do not look directly at the operating LED Retrofit Kit. Do not touch this product with wet hands. Do not disassemble, repair, or alter lamp. Designed for indoor application only. Suitable for wet locations. The luminaire shall be grounded. Be careful not to touch the lamp pins to the metal housing when installing. This Device is not intended for use with emergency exits or emergency lights. Installation by a licensed Electrician recommended. Min. Lamp compartment dimensions 163(Ø) x 185(H)mm Min. Lamp compartment dimensions 130(Ø) x 180(H)mm For more information please visit www.eurilighting.com or call our toll-free number 1-888-743-5766.

Electrical Parameters

Model No.	Input Voltage(V)	Input Frequency (Hz)	Input Current (A)	Input Watts (W)
DLC4-2000e DLC4-2020e DLC4-2040e	120	60	0.12	13

Installation Instructions

Step 1

Turn off the power before installation, remove the diffuser if exists and bulb if necessary and remove the existing trim. Attach the relamping label to the inside of recessed luminaire housing.

Step 2

Twist the lamp base into the lamp holder. (Figure 1)

Step 3

Connected the lamp connector with lamp base connector. (Figure 2)

Step 4

Press both ends of the springs and insert them inside the lamp holder bayonet as shown in Figure 3

Step 5

Push the LED retrofit trim into the recessed light fixture, allowing the torision springs to pull the LED trim up into the recessed light fixture. Continue to push the LED trim until its outer edge is flush against the ceiling surface.

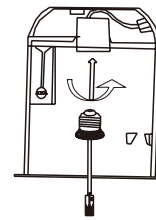

Figure 1

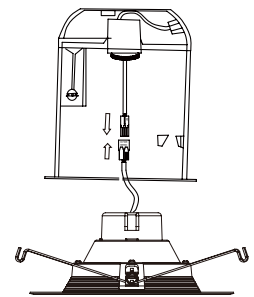

Figure 2

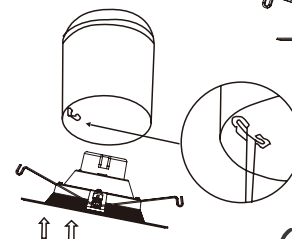

Figure 3

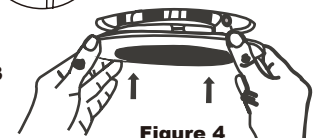

Figure 4